

Appendix:

- Valley outlet's cross sections; all simulated sections by HEC-RAS.

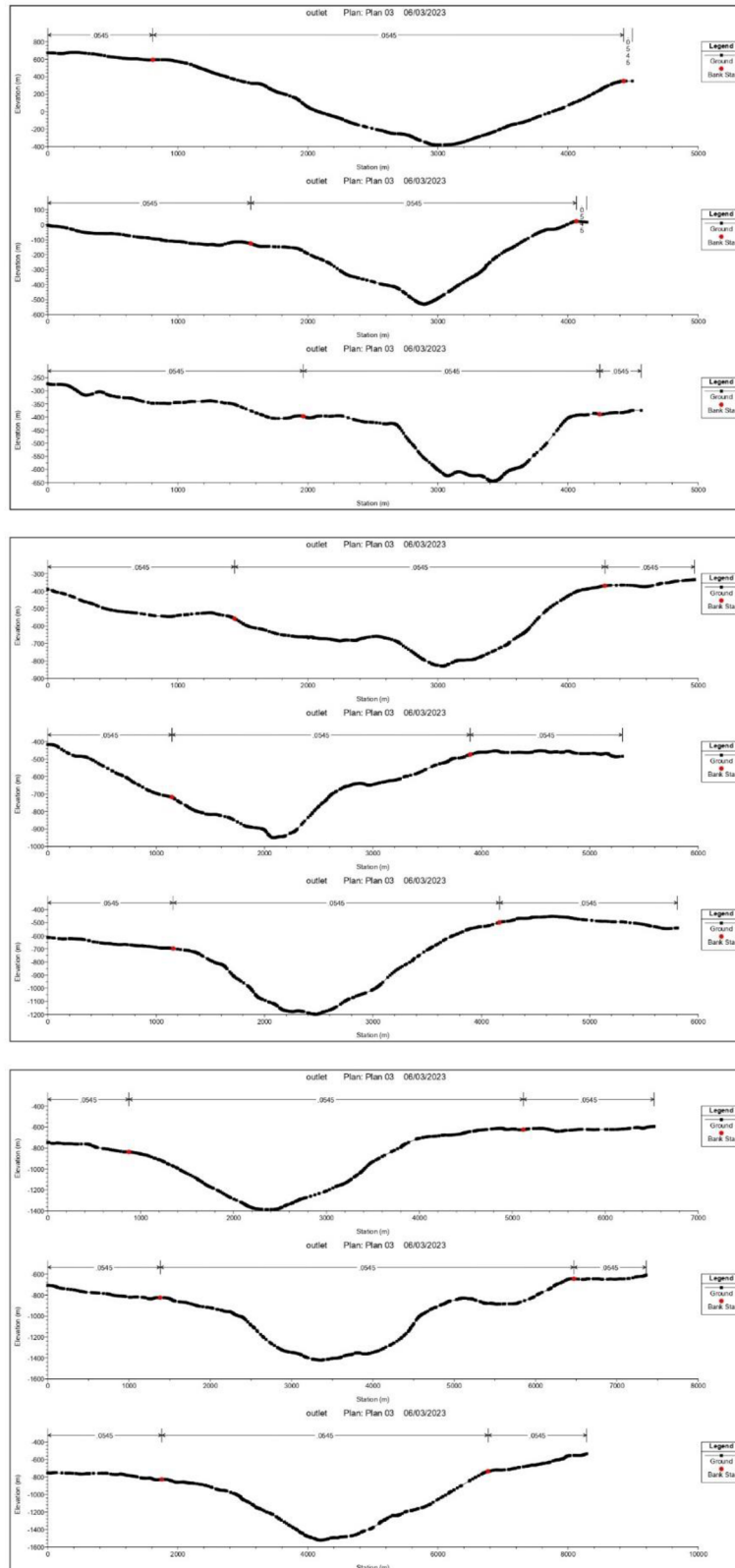

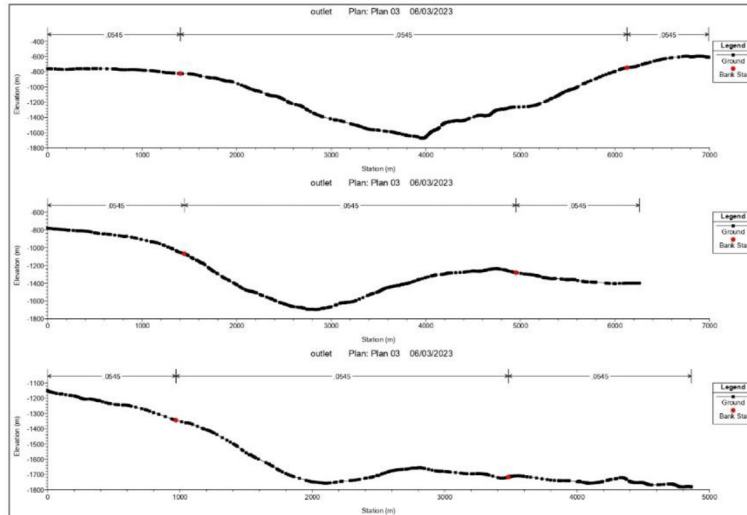

Figure 1:Valley outlet's cross sections; all simulated sections.

- **Table of all pour points used for watershed function.**

Table 1: The exact locations of pour points in projected coordinate system.

FID	Y	X
0	-312807	7874420
1	-398785	7810320
2	-440141	7821440
3	-479558	7671560
4	-594895	7670890
5	-367461	7839190
6	-423983	7764540
7	-578635	7740110